



An  
exotic  
environ at  
an incredible  
habitat

VISHRAAM  
**PRAANA**  
EXOTIC VILLAS



We at Vishraam believe, the best things in life come in small packages. Vishraam 'PRAANA' comprising of just 11 villas is all about living in open spaces with an open mind, where quality of life meets quality of living. Making the best use of space with abundant sunlight and fresh air, we assure you a peaceful life in a secure development. So will you be among the privileged 11 to enjoy pure living pleasure at Vishraam 'PRAANA'- Exotic Villas...

A reputaion of  
INNOVATION, QUALITY AND TRUST



Right  
choice for  
a perfect  
home maker

Reside at a swanky new address in Thrissur. Derived from Sanskrit, Vishraam 'PRAANA' Exotic Villas, symbolizes the dynamic vital life force within all living things. Located near Amala Nagar, 'PRAANA' has just 11 plots with both 3BHK and 4BHK comprising ground and first floor.

A fresh green natural environment in a delightful setting for a perfect home!!

VISHRAAM  
**PRAANA**  
EXOTIC VILLAS



3 BHK



4 BHK

# MAXIM SPACE

The text 'MAXIM SPACE' is rendered in large, white, cut-out letters. The letters are filled with a photograph of a woman in a white patterned shirt and blue jeans holding hands with a young girl in a white patterned dress and tan pants. They are standing on a green lawn under a clear sky.

# Detailing space to the maxim for a cushioned life

Vishraam 'PRAANA' - Exotic Villas are a perfect fusion of function and aesthetics. Imbibing all finesse of elite living, the villa accommodates a convenient car porch as you enter. The space is laid out in a way that, apart from the spacious bedrooms there is provision for a Pooja corner too. An open terrace, a balcony deck, kitchen, dining and living areas, spacious bedrooms with attached bathrooms completes the whole plan for your life's necessities within your reach.

VISHRAAM  
**PRAANA**  
EXOTIC VILLAS





# INNER WORLD

An  
inner world  
that gives  
meaning to  
celebrate life



A peaceful life within a secured development and necessities within your reach, in an unhurried pace. Nature at its best surrounding the villas, makes it a cool haven for all residents. So define the contours of your dreams making the right choice for the right reasons.





Swanky entrance to Vishraam 'PRAANA' Exotic Villas

# PLOT : 1

Area: 2400 Sq.ft | 4 BHK

Carpet Area: 1,850 Sq.ft  
(Excluding sit out, porch, balcony)

Land Area: 6.583 cents

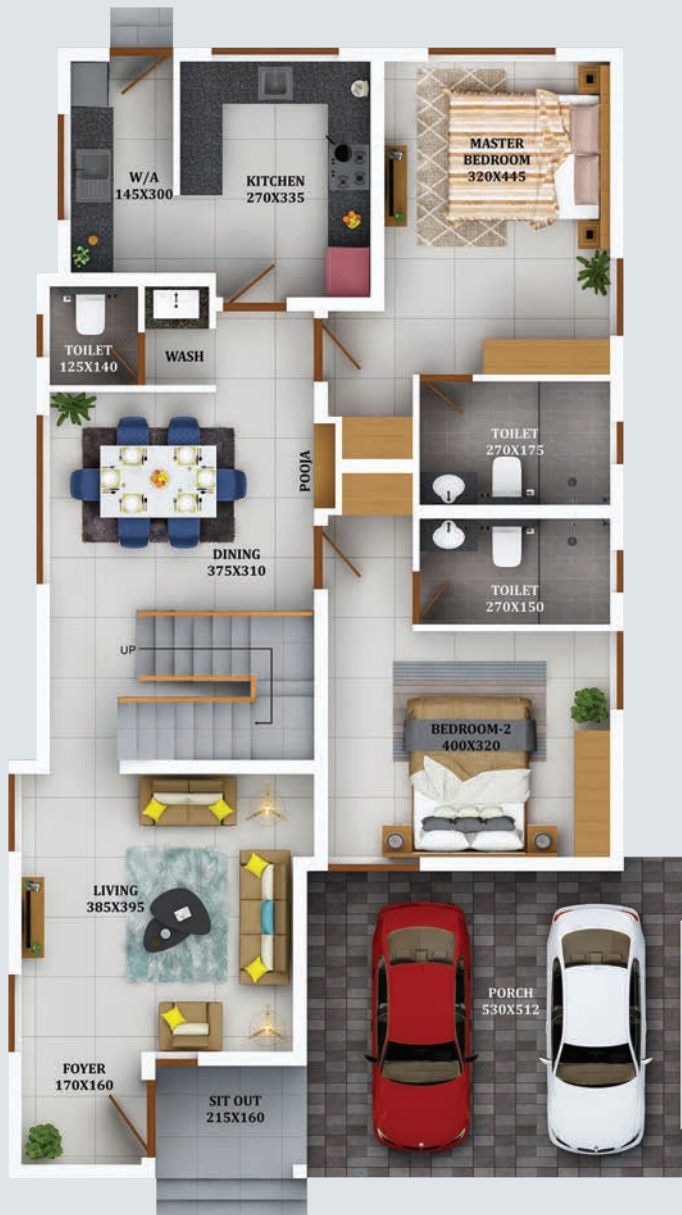
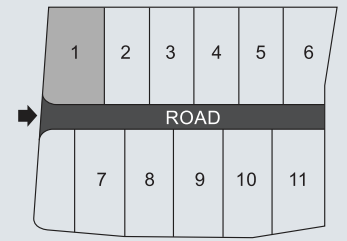

Ground Floor Plan: Area: 1459 Sq.ft



First Floor Plan: Area: 941 Sq.ft

# PLOT : 2, 3, 4, 5

Area: 2101 Sq.ft 3 BHK

Carpet Area: 1,574 Sq.ft  
(Excluding sit out, porch, balcony)

Land Area (2): 5.001 cents  
 Land Area (3): 5.002 cents  
 Land Area (4): 5.005 cents  
 Land Area (5): 5.007 cents

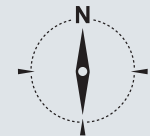
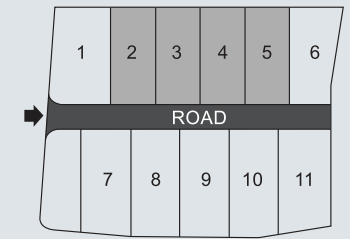

Ground Floor Plan: Area: 1196 Sq.ft



First Floor Plan: Area: 905 Sq.ft

# PLOT : 6

Area: 2063 Sq.ft | 3 BHK

Carpet Area: 1,551 Sq.ft  
(Excluding sit out, porch, balcony)

Land Area: 5.108 cents

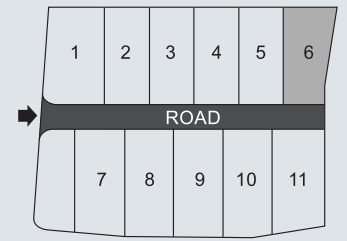

Ground Floor Plan: Area: 1175 Sq.ft



First Floor Plan: Area: 888 Sq.ft

# PLOT : 7

Area: 2444 Sq.ft 4 BHK

Carpet Area: 1,912 Sq.ft  
(Excluding sit out, porch, balcony)

Land Area : 6.019 cents

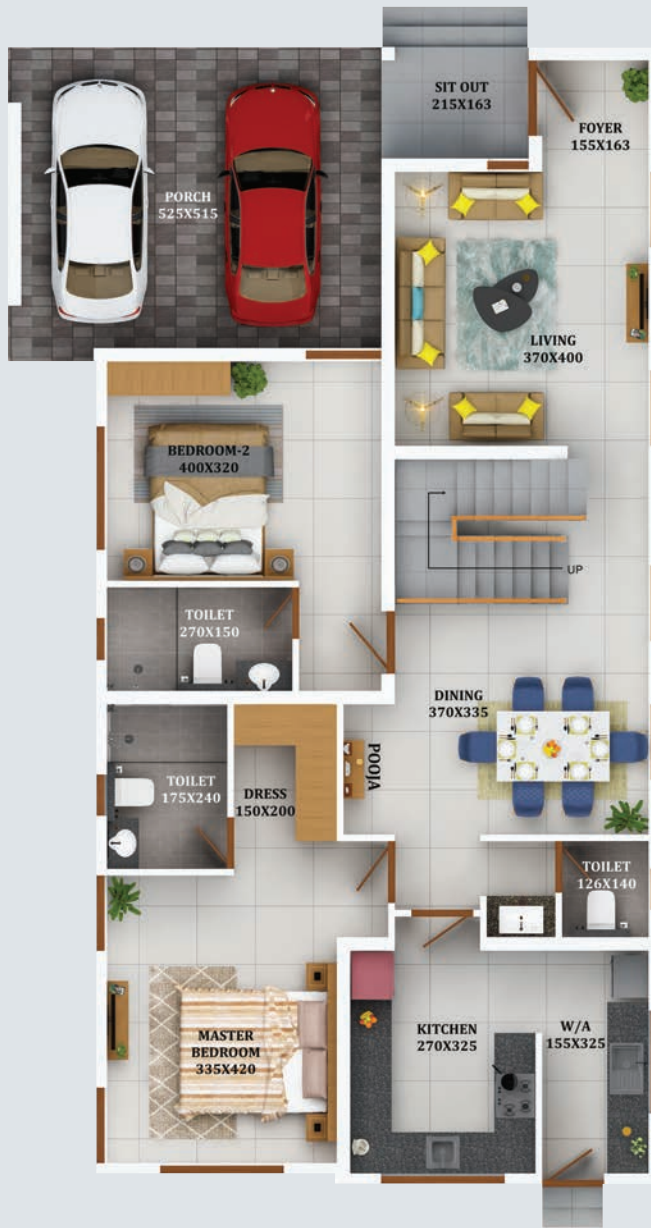
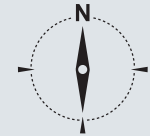
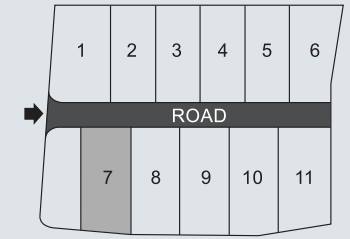

Ground Floor Plan: Area: 1481 Sq.ft

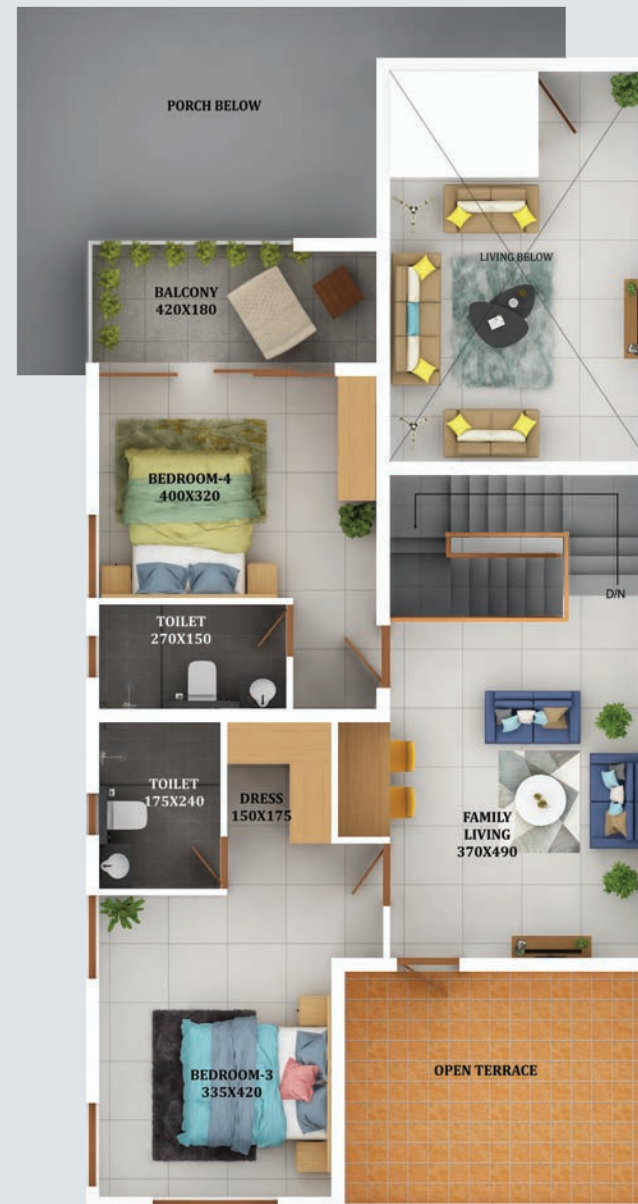

First Floor Plan: Area: 963 Sq.ft

# PLOT : 8, 9, 10

Area: 2502 Sq.ft | 4 BHK

Carpet Area: 1,965 Sq.ft  
(Excluding sit out, porch, balcony)

Land Area (8): 6.079 cents

Land Area (9): 6.097 cents

Land Area (10): 6.056 cents

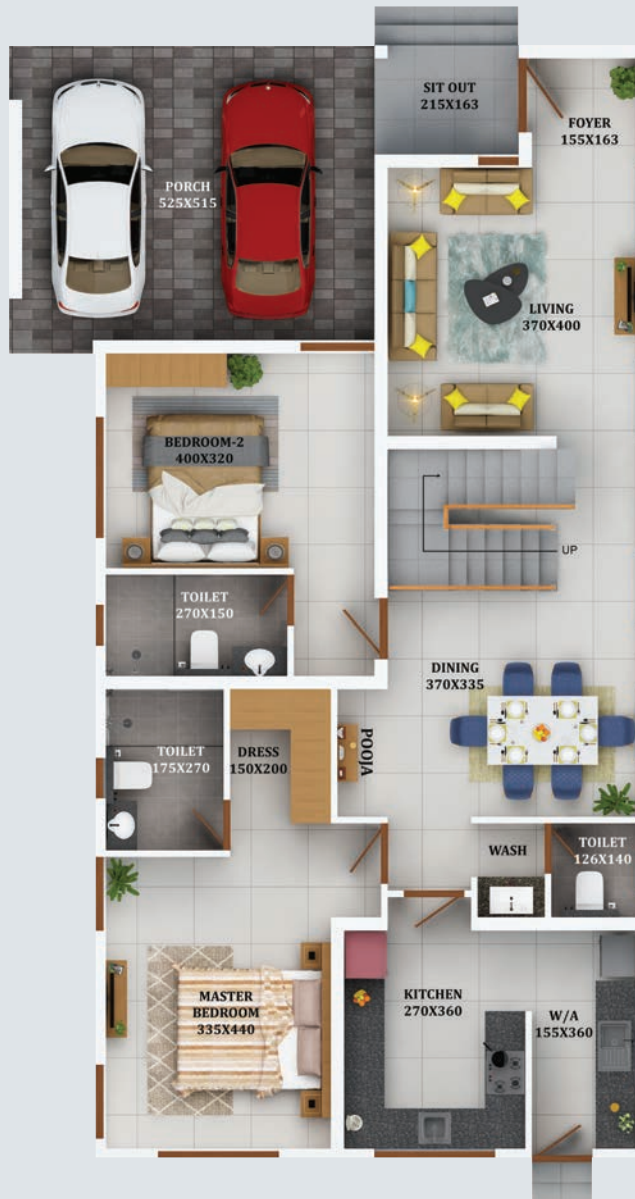
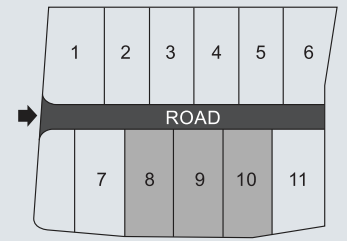

Ground Floor Plan: Area: 1518 Sq.ft

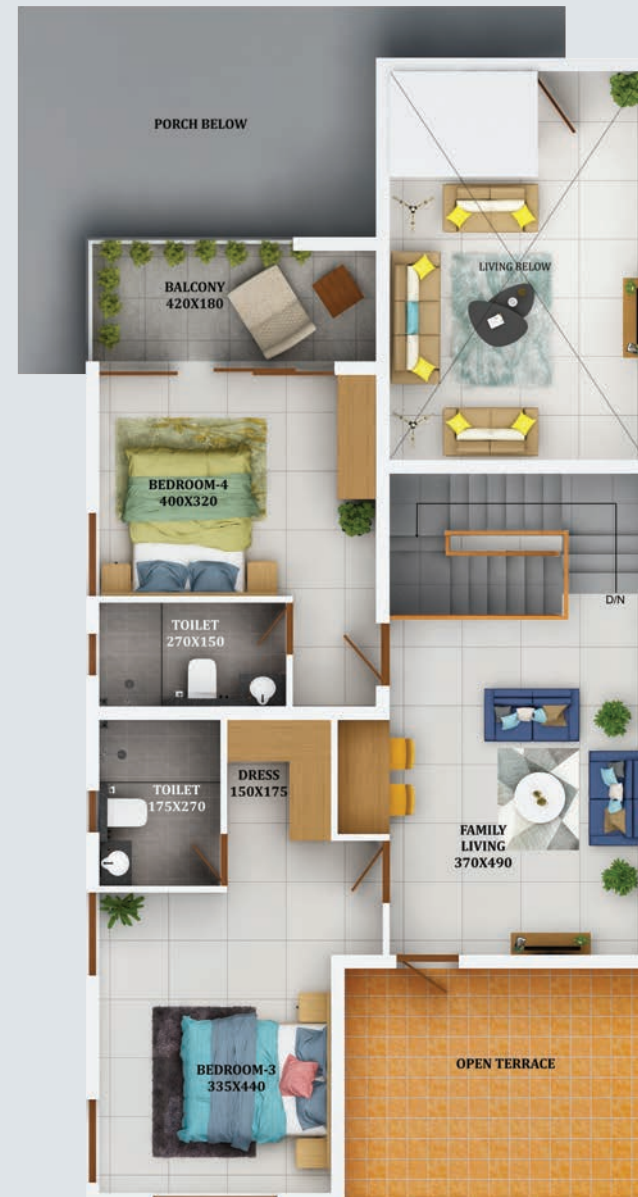

First Floor Plan: Area: 984 Sq.ft

# PLOT : 11

Area: 2519 Sq.ft 4 BHK

Carpet Area: 1,956 Sq.ft  
(Excluding sit out, porch, balcony)

Land Area : 6.100 cents

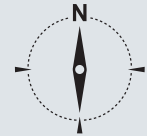
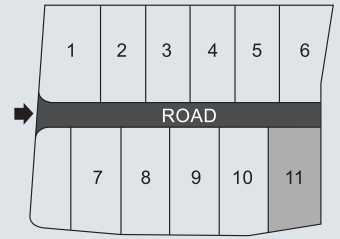

Ground Floor Plan: Area: 1527 Sq.ft



First Floor Plan: Area: 992 Sq.ft

## Club House

Making the best use of space, the Club House occupies a coveted space at the entrance itself. Comprising of ground and first floor, the Club House accommodates an indoor game area, gym and party hall too.







Party Hall



Multi functional Gym

## Amenities

- Clubhouse
  - Gym
  - Indoor game
  - Party Hall
- Waste management
- Gated community
- Compound wall and 24x7 security
- CCTV at vantage points
- Pathway lights
- Security cabin
- Solar powered lighting in common area
- Common area management facility
- Intercom



Living Room



Dining area



## Location



MEMBER

ISO 9001:2015  
ISO 14001:2015  
Integrated Management System  
BUREAU VERITAS  
Certification



**CREDAI**

+91 97466 58888

+91 98952 24433



**VISHRAAM**

• we build smiles •

Near Punkunnam Junction, Thrissur. Kerala - 680 002.

Tel: +91 487 2386168. Email: mail@vishraam.com

[www.vishraam.com](http://www.vishraam.com)